

LONGER

地址：保定国家高新技术产业开发区大学科技园  
6号楼B座3-4层

邮编：071051

销售电话：0312-3138553 3132333 3138011

售后电话：0312-3127877

传真：0312-3168553

Http://www.longerpump.com.cn

E-mail: info@longerpump.com

2019.8  
DG15 Peristaltic Pump Heads

## DG15型蠕动泵泵头 使用说明书

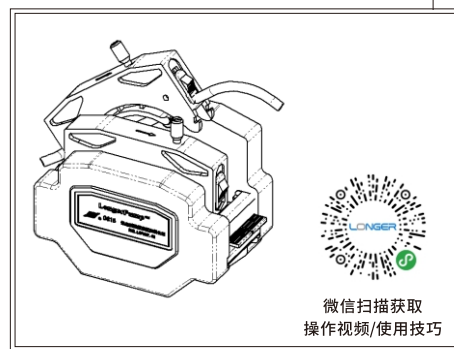

保定兰格恒流泵有限公司

Baoding Longer Precision Pump Co., Ltd.

### 产品简介

DG15系列泵头是为中小流量、多通道流体输送而设计，易于更换和固定软管，压管间隙可微量调节。滚轮均采用优质材料。泵头由本体、滚轮装置和便于拆卸的卡片构成。

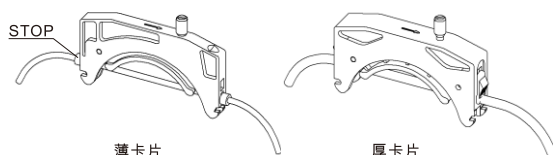

DG15 型泵头性能见下表：

型号	产品编号	卡片材料	滚轮材料	滚轮数	重量 (kg)
DG15-24	0101171	POM	RULON®J	4	0.82
DG15-28	0101172			8	0.67
DG15-48	0101173			8	0.87

型号	流量范围 (mL/min)	转速范围 (rpm)	适用软管
DG15-24	0.9 - 1800	≤ 600	16" 25" 17"
DG15-28	0.028 - 46	≤ 100	0.5×0.8 1×1 2×1
DG15-48			2.4×0.8 13" 14"

泵头材料不耐有机溶剂

### 泵头安装

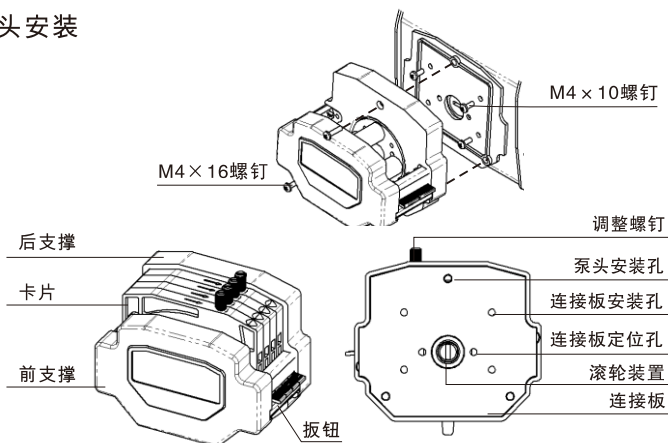

- 1 按动【按钮】取下【卡片】，然后旋下【泵头安装孔】中的3支M4\*16螺钉，使【连接板】与【后支撑】脱离。
- 2 用4支M4\*10螺钉通过【连接板安装孔】将【连接板】与驱动器上的泵头支架紧固。
- 3 通过【泵头安装孔】旋紧3支M4\*16螺钉，将泵头安装在【连接板】上。
- 4 将【卡片】依次安装在泵头上。
- 5 工作状态下，旋动【调整螺钉】，以液体刚好流出为最佳。

旋紧【调整螺钉】时，不要太紧，要求均匀紧固，力量平稳、适中且均匀。

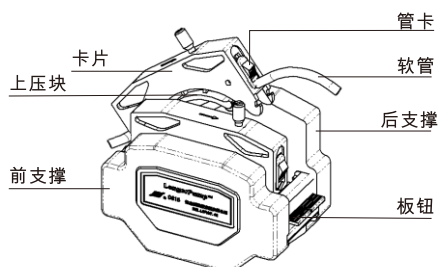

### 安装软管

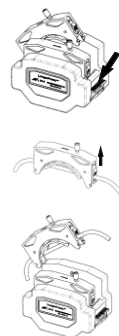

1 依箭头方向按下按钮，卸下卡片

2 分别向上扳动两端管卡将软管插入安装孔，释放两端管卡，拽直软管，并位于上压块的中间部位(如左图)

3 将已装好软管的卡片装到泵头上

薄卡片安装软管时，只需将带STOP的软管直接装入安装槽中即可

### 产品维护

- 在泵不工作时，将压住软管的卡片松开，避免长时间挤压软管使软管产生塑性变形。
- 泵头的滚轮要保持清洁和干燥，否则会加快软管的磨损，缩短软管使用寿命和导致滚轮过早损坏。
- 泵头不耐有机溶剂和强腐蚀性液体，使用时应特别注意。

如出现故障，请您拨打服务电话：0312-3127877

### 保修条款

本产品保修一年，在保修期内如因用户操作不当或超范围使用，本公司不负责保修。在产品寄回维修之前应与销售商或制造商联系，并注明客户联系信息和产品故障现象，以便减少费用和避免延误时间。退回产品时应小心包装并请说明退回原因。

### 外形尺寸

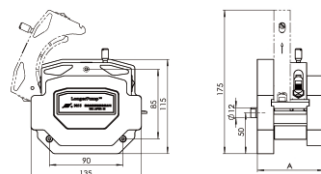

A	泵头型号	泵头厚度
A1	DG15-24	81.5 mm
A2	DG15-28	61.0 mm
A3	DG15-48	81.5 mm

**重要信息：**  
操作前请仔细阅读说明书。

**警告：**

- 软管由于磨损可能产生裂痕，导致液体从软管中溢出，这时可能对人体和设备产生伤害，因此要经常检查并及时更换软管！

**Important Information:**

Please read operating manual carefully before operation.

**Warning:**

- Tubing breakage may result in fluid sprayed from pump. Use appropriate measures to protect operator and equipment. Please check the tubing frequently and changing the tubing in time.

## Introduction

DG15 series pump heads are designed for medium and small flow rates, multi-channel fluids transfer. Easy to change and fix the tubing. Occlusion can be adjusted slightly. The rotors adopt high quality materials. The pump head consists of base, rotor assembly and easy-to-load cartridges.

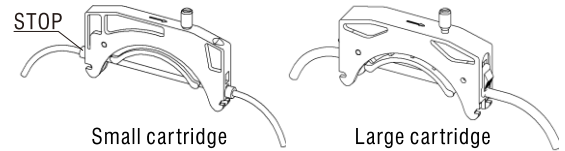

Technical Parameters:

Type	Part Number	Cartridge material	Rotor Material	Number of Rollers	Weight □ Kg □
DG15-24	0101171	POM	RULON J	4	0.82
DG15-28	0101172			8	0.67
DG15-48	0101173				0.87

Type	Flow Rates (mL/min)	Speed (RPM)	Tubing
DG15-24	0.9 - 1800	≤600	
DG15-28	0.028 - 46	≤100	0.5×0.8 1×1 2×1
DG15-48			2.4×0.8 13" 14"

**Note:**

Pump head materials are not organic solvent resistant.

## DG15 Series Pump Head Structure:

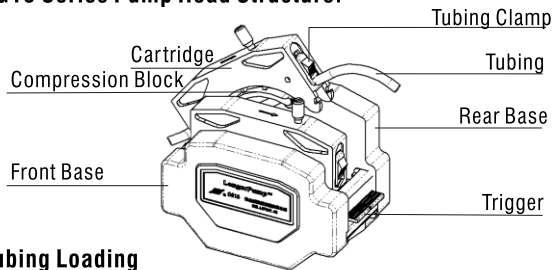

## Tubing Loading



- Press the Trigger according to the arrow head direction and take out the cartridges.
- Push the tubing clamps which are on both sides of the large cartridge upward and insert the tubing to the holes. Release the tubing clamps and straighten the tubing to make the tubing on the middle location of the compression block.
- Load the cartridge with tubing in the pump head.

**Note:** When load the tubing on the small cartridge, just insert the tubing with stops into the slots of the cartridge.

- Press Trigger and take out Cartridge. Turn 3 pieces M4\*16 screws which are in the Mounting Hole for pump head to disengage the Connecting Board and the Rear Base.
- Insert the 4 pieces M4\*10 screws into Mounting Hole for Connecting Board. Tighten the screws to fix the Connecting Board to the pump head bracket of the drive.
- Insert the 3 pieces M4\*16 screws into Mounting Hole for Pump Head. Tighten the screws to install the pump head on the Connecting Board.
- Load the Cartridges on the pump head.
- In running state, turn the Adjusting Knob. The optimum location is the fluids can be Pumped barely.

**Prompt:**

Tighten the Mounting Screws in the same degree. Over-tighten the screws is forbidden.

## Maintenance

- When the pump is idle, we recommend you to release the tubing from pressure.
  - This helps to protect the tubing from unnecessary strain and prolongs its service life
  - Keep rollers clean and dry. This will prolong the service lives of tubing and pump head.
- The surface of the pump head are not organic solvent and aggressive liquids resistant. Please pay attention when using.

**Note:** If a trouble happens, please contact us or our dealers.

## Pump Head Installation

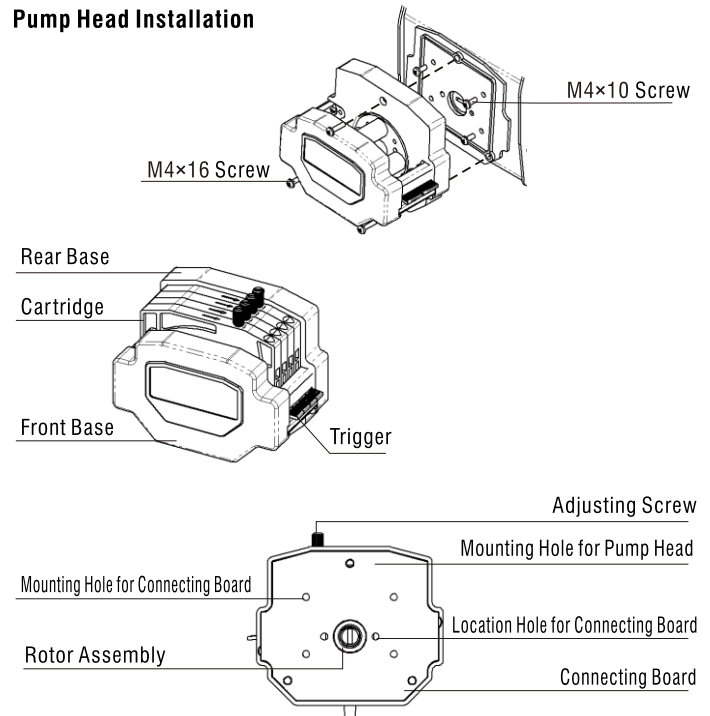

## Warranty

The warranty period for this product is one year. If repair or adjustment is necessary within the warranty period, the problem will be corrected at no charge if it is not due to misuse or abuse on your part, as determined by the manufacturer. Repair costs outside the warranty period, or those resulting from product misuse or abuse, may be invoiced to you.

## Dimensions

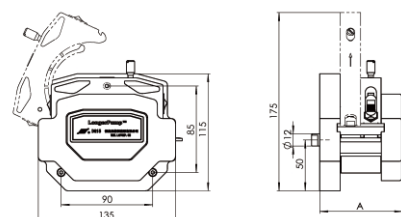

Unit: mm

A	Pump Head	Pump Head Thickness
A1	DG15 - 24	81.5 mm
A2	DG15 - 28	61.0 mm
A3	DG15 - 48	81.5 mm